

Kenton C. Ward, Surveyor

Phone (317) 776-8495

Fax (317) 776-9628

Suite 188

One Hamilton County Square

Noblesville, Indiana 46060-2230

June 1, 2015

To: Hamilton County Drainage Board

Re: Weaver & Hooke Drain Reconstruction & Relocation – IMI

Attached is a petition and plans for the proposed relocation of the Weaver & Hooke Drain. The relocation is being proposed by Irving Materials Incorporated. The proposal is to reconstruct the Weaver & Hooke Drain from approximately Sta. 77+95 which is the approximately 100 feet west of the west right-of-way line for Pennington Road, to Sta. 134+95 of the Weaver & Hooke Drain.

The new drain shall consist of open channel as shown on plans prepared by IMI, dated May 26, 2015 and titled "Weaver & Hooke Drain Relocation". The new drain will intercept the existing Drain at Weaver & Hooke station 77+95 which is shown on the IMI plans as Station 40+00 and will turn north at station 37+07 on the IMI plans and continue north to station 13+00 on the IMI plans at which point it will turn to the west to station 0+00 on the IMI plans which is station 134+95 on the original Weaver & Hooke Drain.

This line will consist of the following lengths:

4,000 feet of open channel

The total length of new open drain shall be 4,000 feet. The 5,700 feet of original open drain between Sta. 77+95 and Sta. 134+95 of the original description shall be vacated. This proposal will reduce the overall total footage of the Weaver & Hooke Drain by 1700 feet.

The cost of the relocation is to be paid by Irving Materials Incorporated. The engineers estimate for the construction is \$455,947.10. The required performance bond of 120% of the engineers estimate is \$547,136.52. The bond provided is in the amount \$547,500.00

120% of the engineers estimate is \$547,136.52. The bond provided is in the amount \$547,500.00

The petitioner has provided the performance bond as follows:

Name of Bonding Company: Continental Casualty Company

Bond Number: 929611329

Bond Date: May 8, 2015

Bond Amount: \$547,500.00

Bond Term: 2 years

Because the proposed reconstruction will be done upon the petitioner's property at the petitioner's expense it meets the requirements of I.C. 36-9-27-52.5 for a hearing. Therefore, I recommend approval by the Board at this time.

Sincerely,



Kenton C. Ward
Hamilton County Surveyor

KCW/adc

HAMILTON COUNTY DRAINAGE BOARD
NOBLESVILLE, INDIANA

Revised June 1997

FILED

MAY 29 2015

IN RE: Weaver & Hooke Drain)
Hamilton County, Indiana)

OFFICE OF HAMILTON COUNTY SURVEYOR

PETITION FOR RELOCATION AND RECONSTRUCTION

Irving Materials Stony Creek Quarry (hereinafter "Petitioner"),

hereby petitions the Hamilton County Drainage Board for authority to relocate and improve a section of the Weaver & Hooke Drain, and in support of said petition advises the Board that:

1. Petitioner owns real estate through which a portion of the Weaver & Hooke Drain runs.
2. Petitioner plans to develop its real estate with roads, buildings, utilities, storm drains, sanitary sewers and other structures.
3. Petitioner's proposed development of its real estate will require relocation and reconstruction of a portion of the Weaver & Hooke Drain, as specifically shown on engineering plans and specifications filed with the Hamilton County Surveyor.
4. The work necessary for the proposed relocation and reconstruction will be undertaken at the sole expense of the Petitioner and such work will result in substantial improvement to the Weaver & Hooke Drain, without cost to other property owners on the watershed of the Weaver & Hooke Drain.
5. Proposed relocation and reconstruction will not adversely affect other land owners within the drainage shed.
6. Petitioner requests approval of the proposed relocation and reconstruction under IC 36-9-27-52.5.

WHEREFORE, Petitioner requests that an Order issued from the Hamilton County Drainage Board authorizing relocation and reconstruction of the Weaver & Hooke Drain, in conformance with applicable law and plans and specifications on file with the Hamilton County Surveyor.

Doug Layman
Signed
Doug Layman Area Manager
Printed Irving Materials

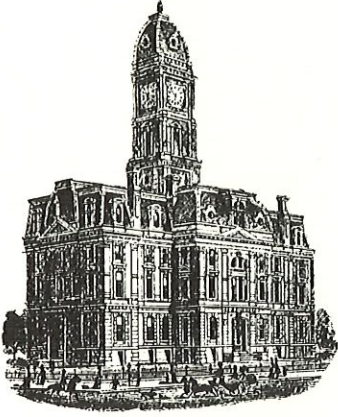

H.C.W.

SURVEYOR'S OFFICE
Hamilton County

Kenton C. Ward, CFM
Surveyor of Hamilton County
Phone (317) 776-8495
Fax (317) 776-9628

Suite 188
One Hamilton County Square
Noblesville, Indiana 46060-2230

To: Hamilton County Drainage Board

April 2, 2018

Re: Weaver & Hooke Regulated Drain Reconstruction
Final Inspection Report

FINAL REPORT

This is the inspector's final report on the Weaver & Hooke Regulated Drain Reconstruction, located in section 35, Township 19 north and Range 5 east, Wayne Township in Hamilton County, Indiana.

The Date of the Surveyor's Report for the Weaver & Hooke Regulated Drain Reconstruction was June 1, 2015. The reconstruction was approved by the Board on June 8, 2015 (Hamilton County Drainage Board Minutes Book (Book) 16 Pages 217 - 218). This was a 52.5 reconstruction hearing. This reconstruction was paid for by Irving Materials Incorporated (IMI). The engineer's estimate for the reconstruction was \$455,947.10. A performance bond for \$547,500.00 was provided by IMI. This amount is 120% of the engineer's estimate.

The reconstruction consisted of constructing 3569 feet of new open ditch, intercepting the existing Drain at Weaver & Hooke station 78+14 which is shown on the IMI plans as Station 40+00 and then turns north at station 37+07 on the IMI plans and continue north to station 13+00 on the IMI plans at which point it turns to the west to station 0+00 on the IMI plans. From station 0+00 on the IMI plans it enters an existing channel 259 feet in length and enters the existing open ditch which is station 131+01 on the original Weaver & Hooke Drain.

The 5287 feet of original open drain between Sta. 78+14 and Sta. 131+01 of the original description shall be vacated. This reconstruction/relocation reduces the overall total footage of the Weaver & Hooke Drain by 1459 feet.

The final inspection of the reconstruction was on October 27, 2016.

The as-built (record) drawings were prepared by Miller Surveying for IMI and was received by this office on March 22, 2018. A certificate of completion and compliance was received in the Hamilton County Surveyor's Office in February 2017. I recommend the Board approve the reconstruction as complete and acceptable and release the performance bond provided by IMI.

Respectfully,

Andrew Conover
Inspector

CERTIFICATE OF COMPLETION AND COMPLIANCE

To: Hamilton County Surveyor

Re: WEAVER & HOOKE DRAIN

I hereby certify that:

1. I am a Registered Land Surveyor or Engineer in the State of Indiana.
2. I am familiar with the plans and specifications for the above referenced subdivision.
3. I have personally observed and supervised the completion of the drainage facilities for the above referenced subdivision.
4. The drainage facilities within the above referenced subdivision to the best of my knowledge, information and belief have been installed and completed in conformity with all plans and specifications.
5. The drainage facilities within the above referenced subdivision to the best of my knowledge, information and belief have been correctly represented on the Record Drawings, Digital Record Drawings and the Structure Data Spreadsheet.

Signature: *K. Nathan Althouse* Date: 2-24-2017
Type or Print Name: K. Nathan Althouse
Business Address: MILLER SURVEYING INC
948 CONNER STREET
Telephone Number: 317-773-2644

SEAL

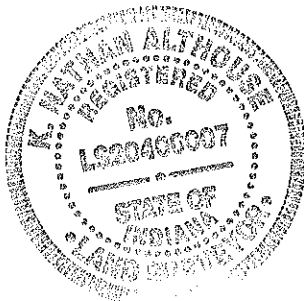

INDIANA REGISTRATION NUMBER

LS20400007

AS-BUILT SURVEY WEAVER AND HOOKE DRAIN

PART OF THE S.W. 1/4, SECTION 35-19-5
WAYNE TOWNSHIP, HAMILTON COUNTY, INDIANA

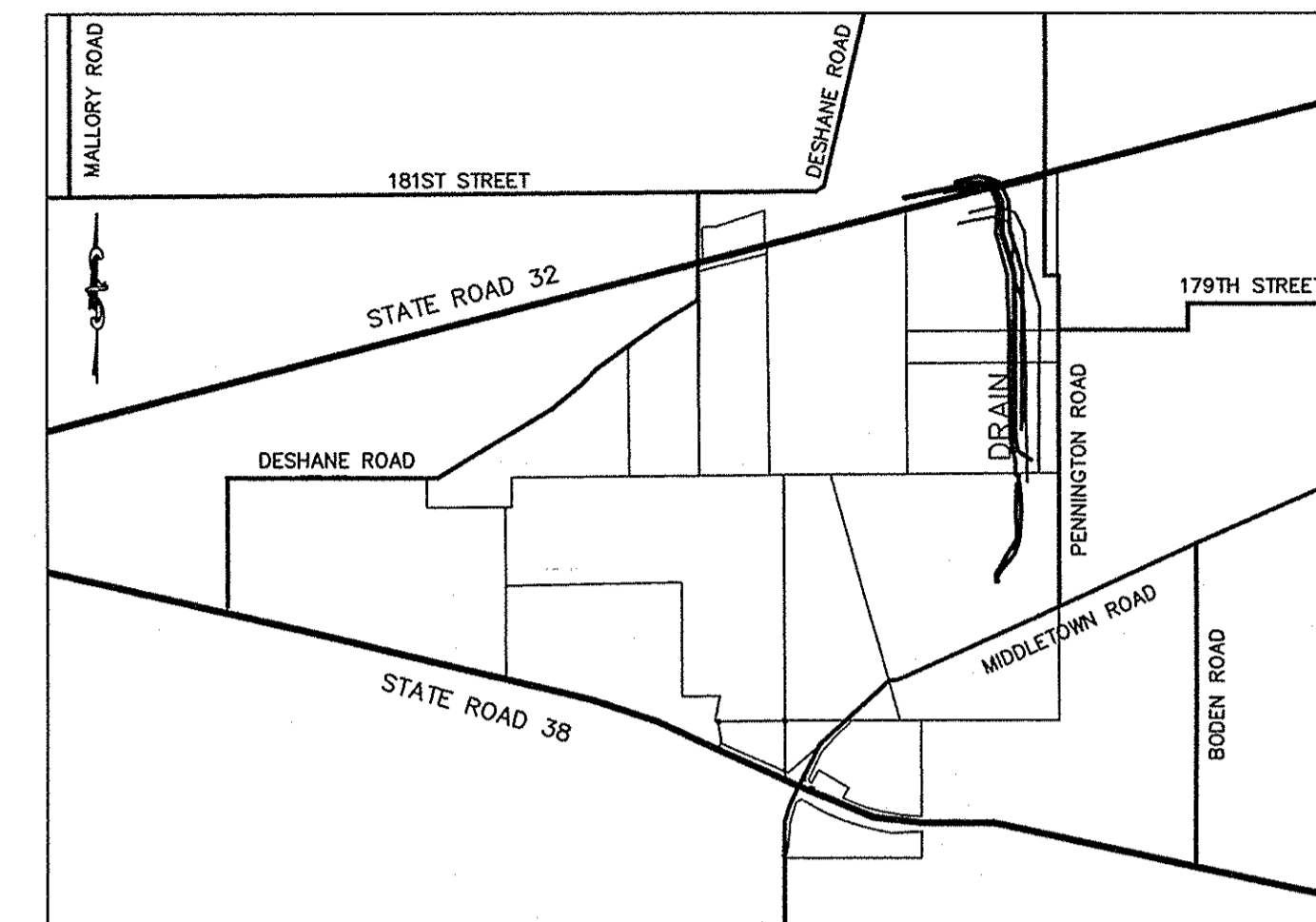

This information was gathered for input into the Hamilton County Geographic Information System (GIS). This document is considered an official record of the GIS.
Entry Date: 2/18
Entered By: SLM

BENCHMARK INFORMATION

HORIZONTAL AND VERTICAL CONTROL:

COORDINATE SYSTEM:
US STATE PLANE 1983 (AT GROUND)

PROJECT DATUM:
WORLD GEODETIC SYSTEM (WGS 1984)

VERTICAL DATUM
NAVD 88

ZONE:
INDIANA EAST 1301

GEOD MODEL:
GEOD12A (CONUS)

COORDINATE UNITS US SURVEY FEET
DISTANCE UNITS US SURVEY FEET
HEIGHT UNITS US SURVEY FEET

FLOOD ZONE DEFINITION

ZONE	EXPLANATION
"A"	AREAS OF 100-YEAR FLOOD; BASE FLOOD ELEVATIONS AND HAZARD FACTORS NOT DETERMINED
"AE"	SPECIAL FLOOD HAZARD AREA INUNDATED BY THE 100 YEAR FLOOD. BASE FLOOD ELEVATION DETERMINED.
"X"	AREAS DETERMINED TO BE OUTSIDE 500-YEAR FLOODPLAIN.

THE SUBJECT PROPERTY IS LOCATED IN A SPECIAL FLOOD HAZARD AREA AS ESTABLISHED BY THE FEDERAL EMERGENCY MANAGEMENT AGENCY NATIONAL FLOOD INSURANCE PROGRAM AS PER SCALED INTERPRETATION OF FLOOD RATE MAP #18057C0170G. AREA IN ZONE "AE", "A", AND "X" MAP DATED 11-19-2014.

CERTIFICATE OF COMPLETION AND COMPLIANCE

CERTIFICATE OF COMPLETION AND COMPLIANCE

TO: HAMILTON COUNTY SURVEYOR

RE: WEAVER & HOOKE DRAIN

I HEREBY CERTIFY THAT:

- I AM A REGISTERED LAND SURVEYOR OR ENGINEER IN THE STATE OF INDIANA.
- I AM FAMILIAR WITH THE PLANS AND SPECIFICATIONS FOR THE ABOVE REFERENCED SUBDIVISION.
- I HAVE PERSONALLY OBSERVED AND SUPERVISED THE COMPLETION OF THE DRAINAGE FACILITIES FOR THE ABOVE REFERENCED SUBDIVISION.
- THE DRAINAGE FACILITIES WITHIN THE ABOVE REFERENCED SUBDIVISION TO THE BEST OF MY KNOWLEDGE, INFORMATION AND BELIEF HAVE BEEN INSTALLED AND COMPLETED IN CONFORMITY WITH ALL PLANS AND SPECIFICATIONS.
- THE DRAINAGE FACILITIES WITHIN THE ABOVE REFERENCED SUBDIVISION TO THE BEST OF MY KNOWLEDGE, INFORMATION AND BELIEF HAVE BEEN CORRECTLY REPRESENTED ON THE RECORD DRAWINGS, DIGITAL RECORD DRAWINGS AND THE STRUCTURE DATA SPREADSHEET.

SIGNATURE: *K. Nathan Althouse* DATE: 2/24/2017

TYPE OR PRINT NAME: K. NATHAN ALTHOUSE

BUSINESS ADDRESS: MILLER SURVEYING, INC
948 CONNER STREET
NOBLESVILLE, IN 46060

TELEPHONE NUMBER: 317-773-2644

SEAL INDIANA REGISTRATION NUMBER #LS20400007



CERTIFICATION BY SURVEYOR

The attached ASBUILT DRAWINGS, page PAGE 1 OF 1, to the best of my knowledge and belief a true and correct representation of the AS-BUILT REGULATED DRAIN installation.

K. Nathan Althouse 2/27/2017

Nathan Althouse #LS20400007
Date 2/24/2017
Miller Surveying, Inc.
948 Conner Street
Noblesville, IN 46060
(317) 773-2644
000.00 = DESIGN VALUE
(000.00) = AS-BUILT VALUE



FILED

MAR 22 2018

OFFICE OF HAMILTON COUNTY SURVEYOR

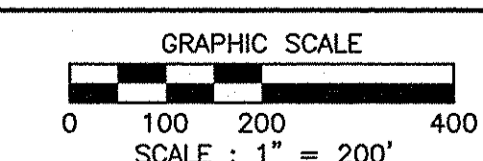

REVISIONS

REV. DATE	BY	DESCRIPTION
3-21-18	KNA	REVISED ON PROPOSED PROFILE

MILLER SURVEYING INC.
948 CONNER STREET
NOBLESVILLE, INDIANA 46060
PH. # (317) 773-2644 FAX 773-2694

LOCATION: PART OF THE S.W. 1/4 SECTION 35-19-5 WAYNE TOWNSHIP, HAMILTON COUNTY, INDIANA
DRAWN BY: KNA PREPARED BY: KNA
SCALE: 1" = 200' FIELD BOOK:
DATE: 2/22/2017 PAGE:
FIELD WORK COMPLETED: 2/14/2017
CLIENT: IMI JOB NUMBER SURVEY 4 FILE:
DESCRIPTION: AS-BUILT B37070

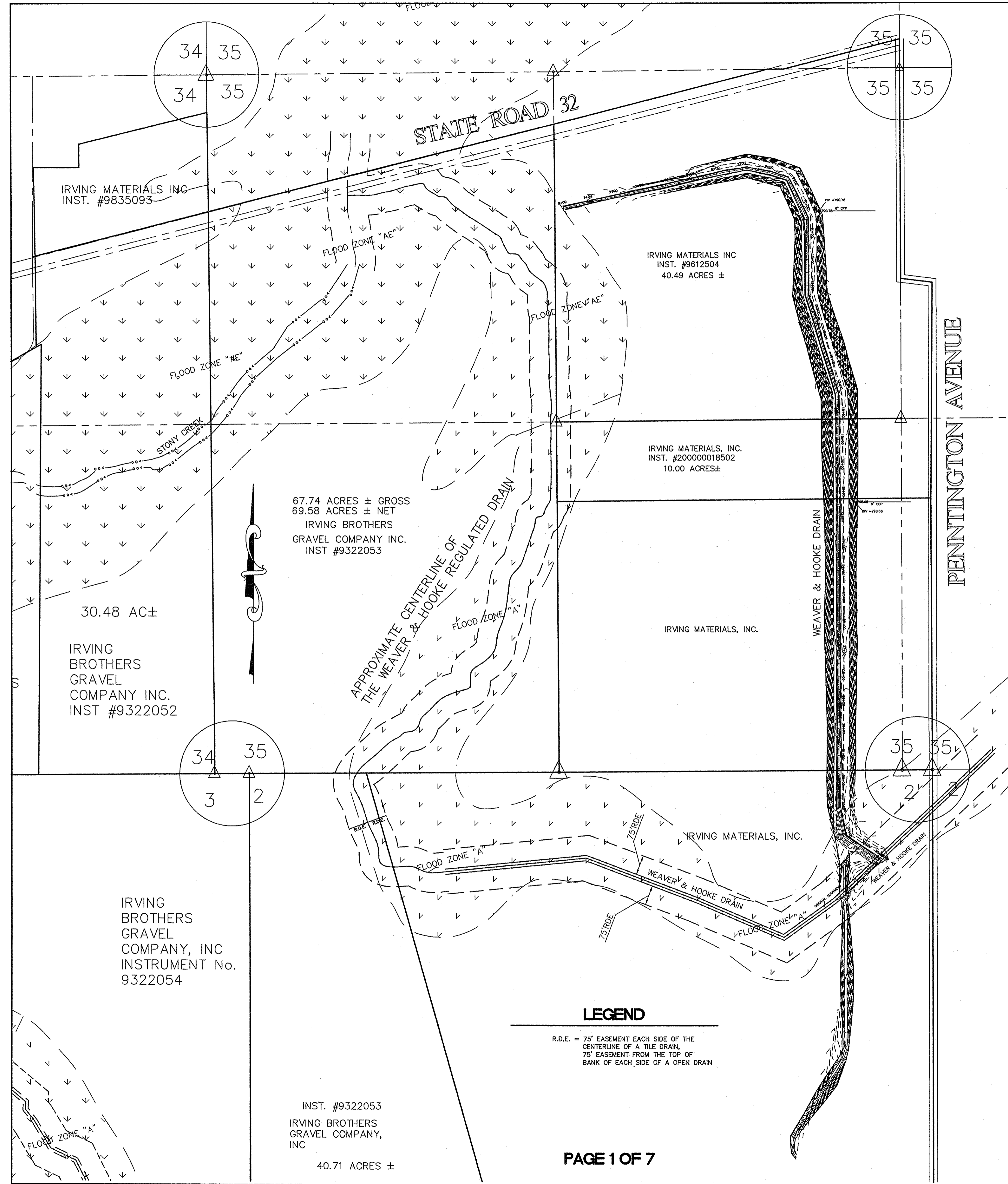

LEGEND

R.D.E. = 75' EASEMENT EACH SIDE OF THE CENTERLINE OF A TILE DRAIN, 75' EASEMENT FROM THE TOP OF BANK OF EACH SIDE OF AN OPEN DRAIN

INST. #9322053
IRVING BROTHERS
GRAVEL COMPANY,
INC
40.71 ACRES ±

This copy printed from Digital Archive of the Hamilton County Surveyor's Office; One Hamilton Co. Square, Ste., Noblesville, In 46060

AS-BUILT SURVEY
WEAVER AND HOOKE DRAIN
 PART OF THE S.W. 1/4, SECTION 35-19-5
 WAYNE TOWNSHIP, HAMILTON COUNTY, INDIANA

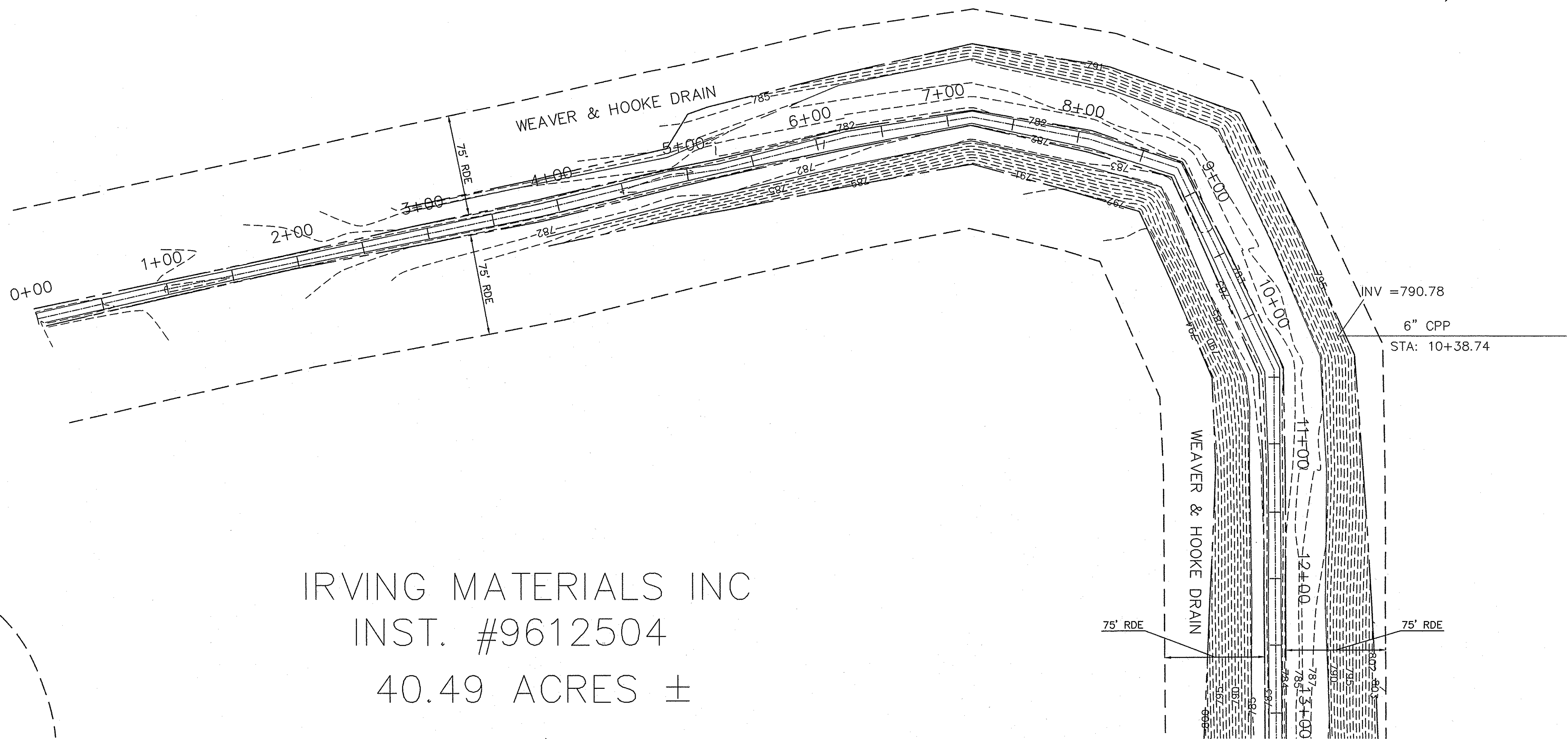
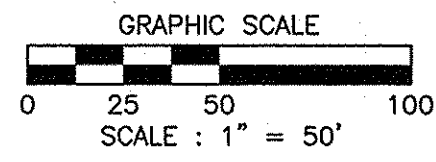

IRVING MATERIALS INC
 INST. #9612504
 40.49 ACRES ±

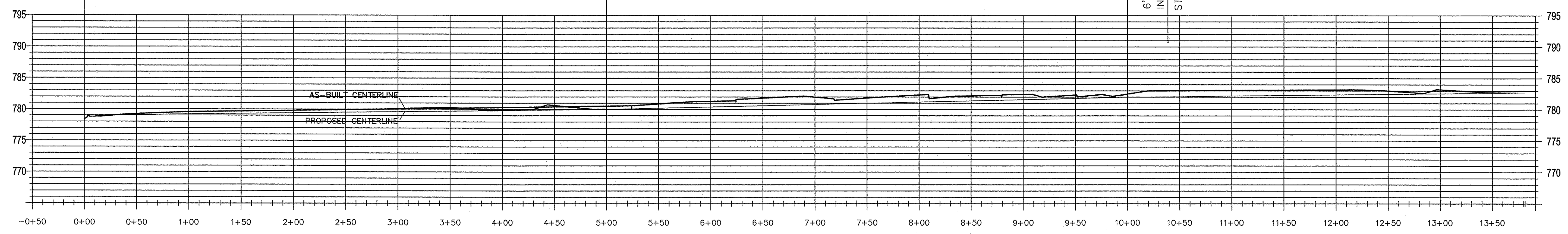

FILED

MAR 22 2018
 OFFICE OF HAMILTON COUNTY SURVEYOR

LEGEND

R.D.E. = 75' EASEMENT EACH SIDE OF THE CENTERLINE OF A TILE DRAIN, 75' EASEMENT FROM THE TOP OF BANK OF EACH SIDE OF AN OPEN DRAIN

REVISIONS		
REV. DATE	BY	DESCRIPTION
3-21-18	KNA	REVISED ON PROPOSED PROFILE

MILLER SURVEYING INC. 948 CONNER STREET NOBLESVILLE INDIANA 46060 PH. # (317) 773-2644 FAX 773-2694		DRAWN BY: KNA PREPARED BY: KNA
		LOCATION: PART OF THE S.W. 1/4 SECTION 35-19-5 WAYNE TOWNSHIP, HAMILTON COUNTY, INDIANA DATE: 2/22/2017 CLIENT: IMI DESCRIPTION: AS-BUILT
SCALE: 1" = 200' FIELD WORK COMPLETED: 2/14/2017 JOB NUMBER: B37070	FIELD BOOK: PAGE: SURVEY 4 FILE:	JOB NUMBER: B37070

This copy printed from Digital Archive of the Hamilton County Surveyor's Office, One Hamilton Co. Square, Ste., Noblesville, In 46060

AS-BUILT SURVEY

WEAVER AND HOOKE DRAIN

PART OF THE S.W. 1/4, SECTION 35-19-5
WAYNE TOWNSHIP, HAMILTON COUNTY, INDIANA

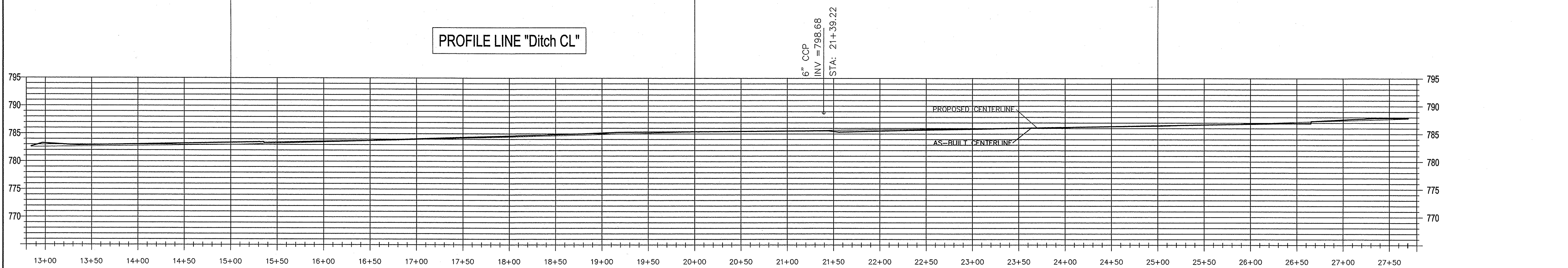
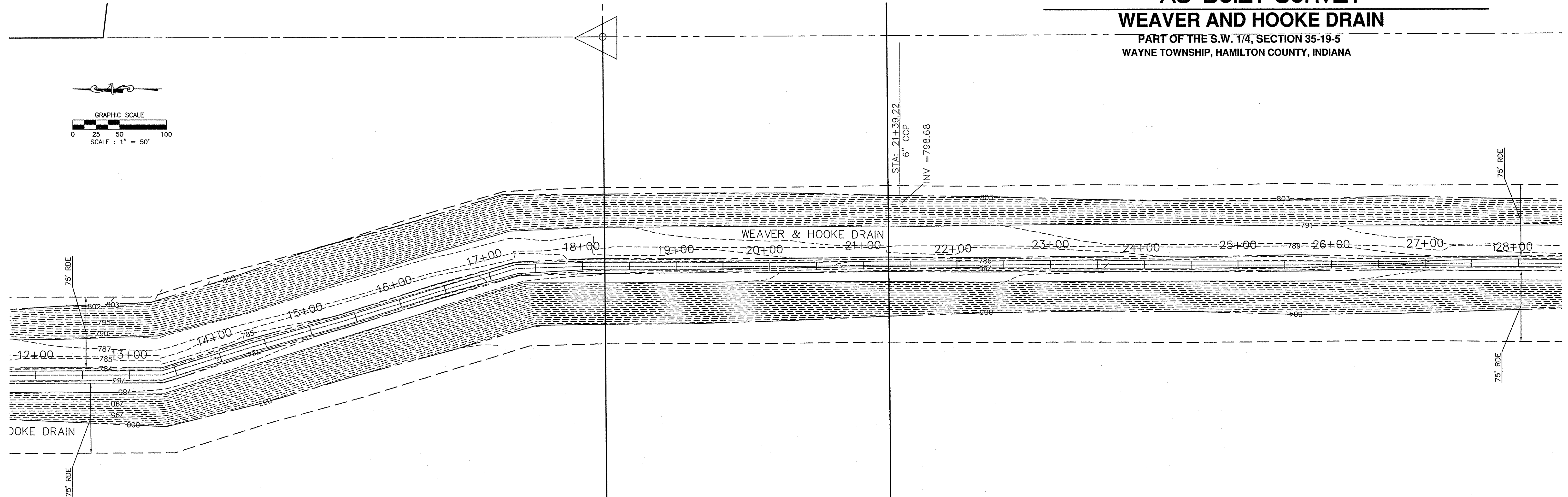
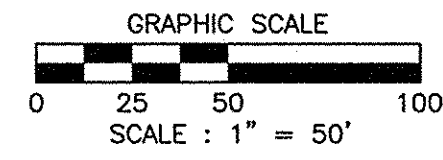

LEGEND

R.D.E. = 75' EASEMENT EACH SIDE OF THE CENTERLINE OF A TILE DRAIN,
75' EASEMENT FROM THE TOP OF BANK OF EACH SIDE OF AN OPEN DRAIN

FILED

MAR 22 2018

OFFICE OF HAMILTON COUNTY SURVEYOR

REVISIONS			MILLER SURVEYING INC.	
REV. DATE	BY	DESCRIPTION	948 CONNER STREET NOBLESVILLE INDIANA 46060 PH. # (317) 773-2644 FAX 773-2694	
3-21-18	KNA	REVISED ON PROPOSED PROFILE	LOCATION: PART OF THE S.W. 1/4 SECTION 35-19-5 WAYNE TOWNSHIP, HAMILTON COUNTY, INDIANA	DATE: 2/22/2017
			FIELD WORK COMPLETED: 2/14/2017	CLIENT: IMI
			DESCRIPTION: AS-BUILT	JOB NUMBER: B37070
				PREPARED BY: KNA
				SCALE: 1" = 200'
				PAGE: SURVEY 4 FILE:

AS-BUILT SURVEY

WEAVER AND HOOKE DRAIN

PART OF THE S.W. 1/4, SECTION 35-19-5
WAYNE TOWNSHIP, HAMILTON COUNTY, INDIANA

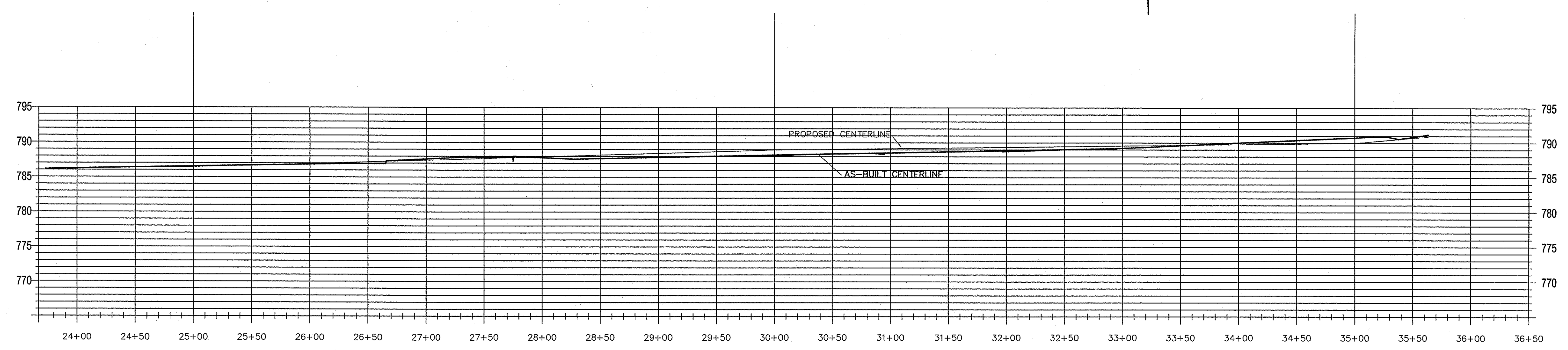
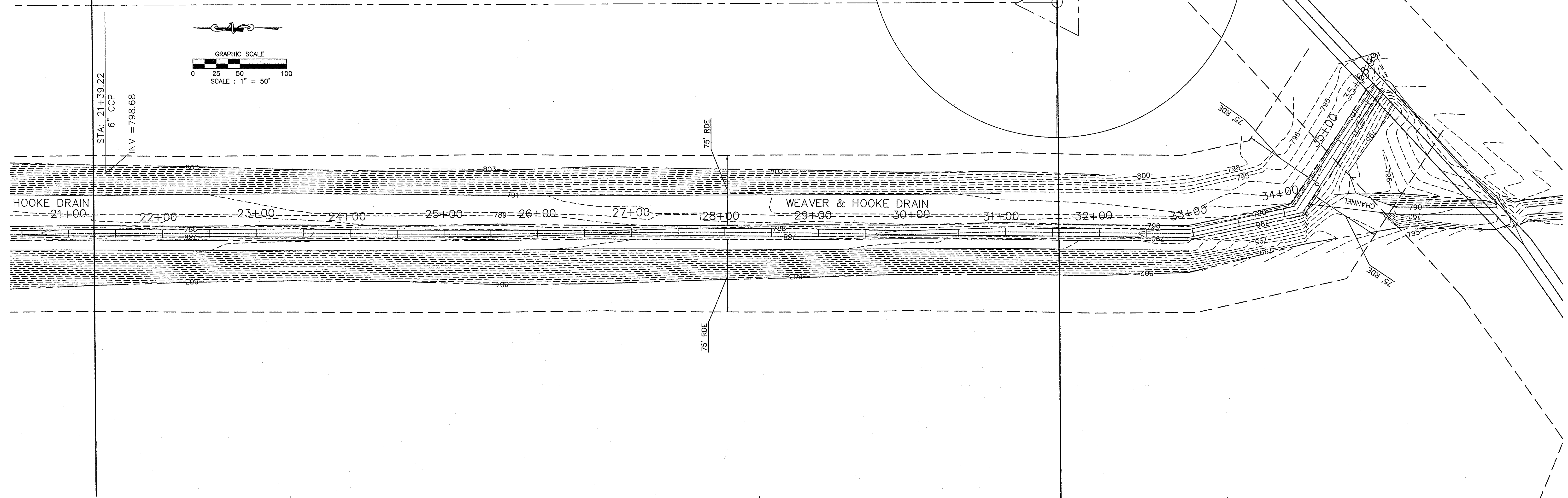
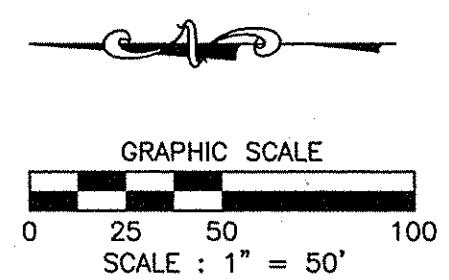

LEGEND

R.D.E. = 75' EASEMENT EACH SIDE OF THE CENTERLINE OF A TILE DRAIN,
75' EASEMENT FROM THE TOP OF BANK OF EACH SIDE OF AN OPEN DRAIN

FILED

MAR 22 2018

OFFICE OF HAMILTON COUNTY SURVEYOR

REVISIONS			MILLER SURVEYING INC.	
REV. DATE	BY	DESCRIPTION	948 CONNER STREET NOBLESVILLE INDIANA 46060 PH. # (317) 773-2644 FAX 773-2694	
3-21-18	KNA	REVISED ON PROPOSED PROFILE	LOCATION: PART OF THE S.W. 1/4 SECTION 35-19-5 WAYNE TOWNSHIP, HAMILTON COUNTY, INDIANA	DRAWN BY: KNA PREPARED BY: KNA
			FIELD WORK COMPLETED: 2/14/2017	SCALE: 1" = 200' FIELD BOOK:
			CLIENT: IMI	DATE: 2/22/2017 PAGE:
			DESCRIPTION: AS-BUILT	JOB NUMBER SURVEY 4 FILE:
				B37070

AS-BUILT SURVEY

WEAVER AND HOOKE DRAIN
 PART OF THE S.W. 1/4, SECTION 35-19-5
 WAYNE TOWNSHIP, HAMILTON COUNTY, INDIANA

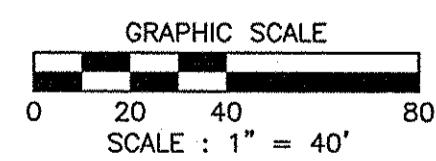
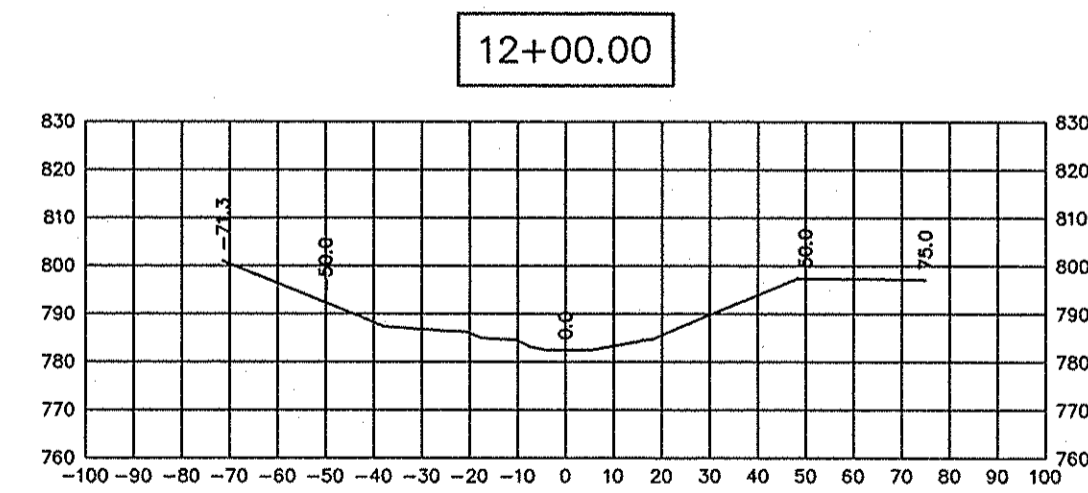
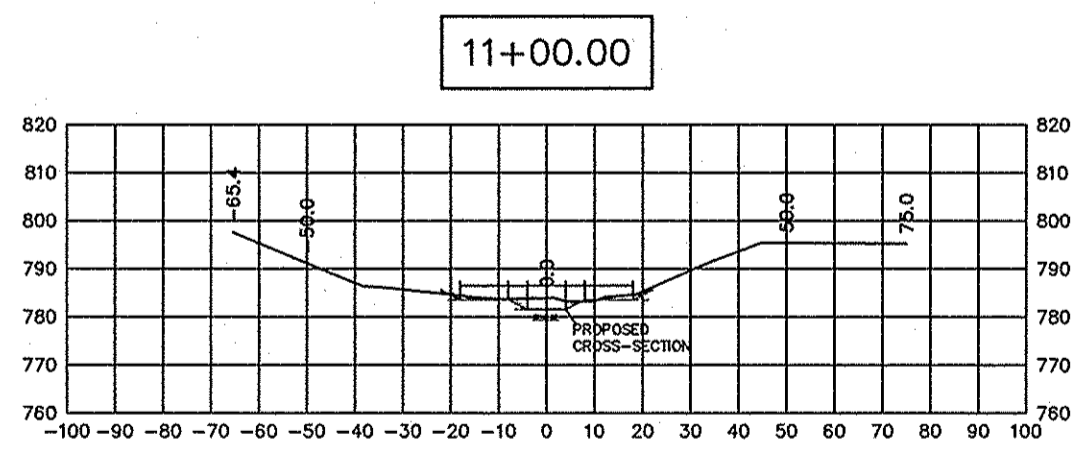
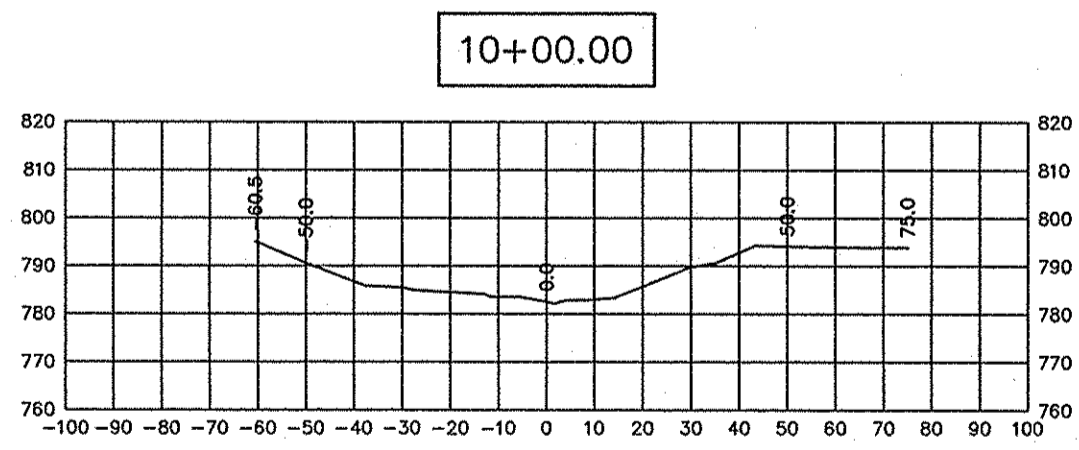
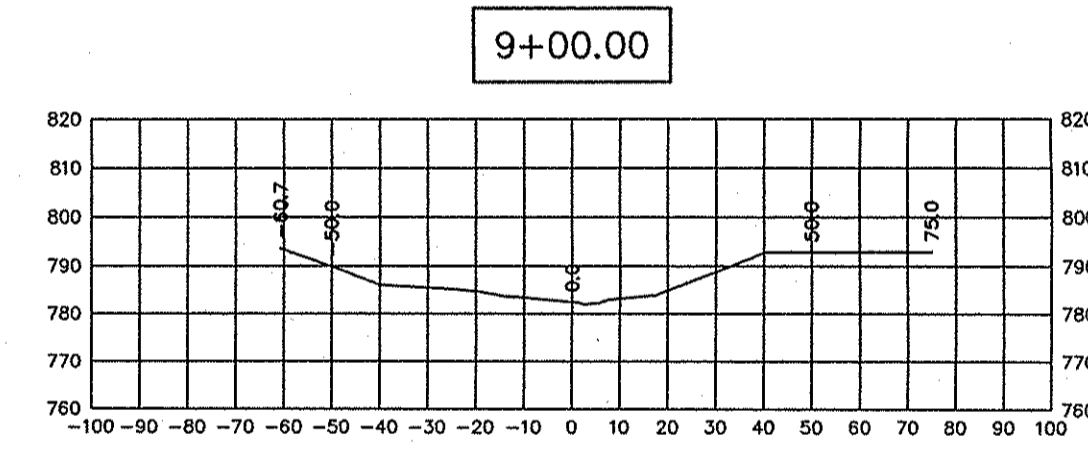
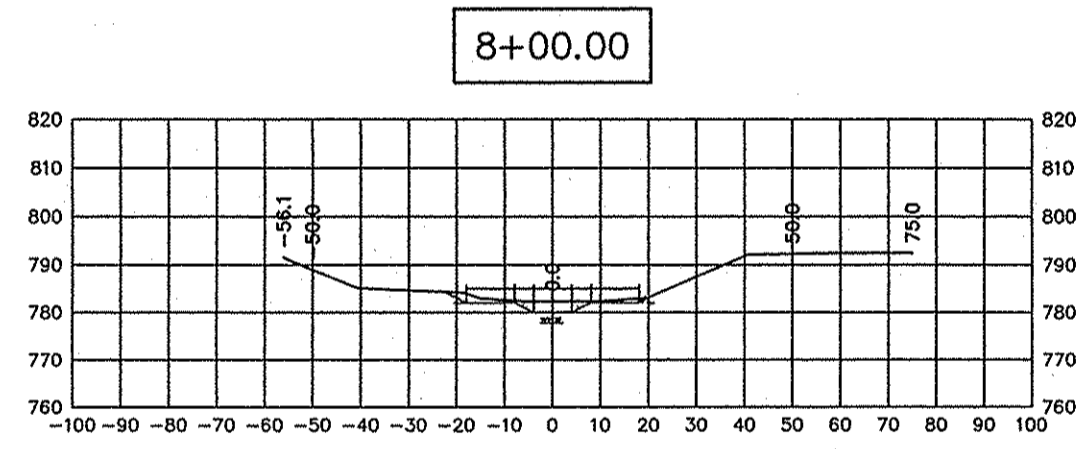
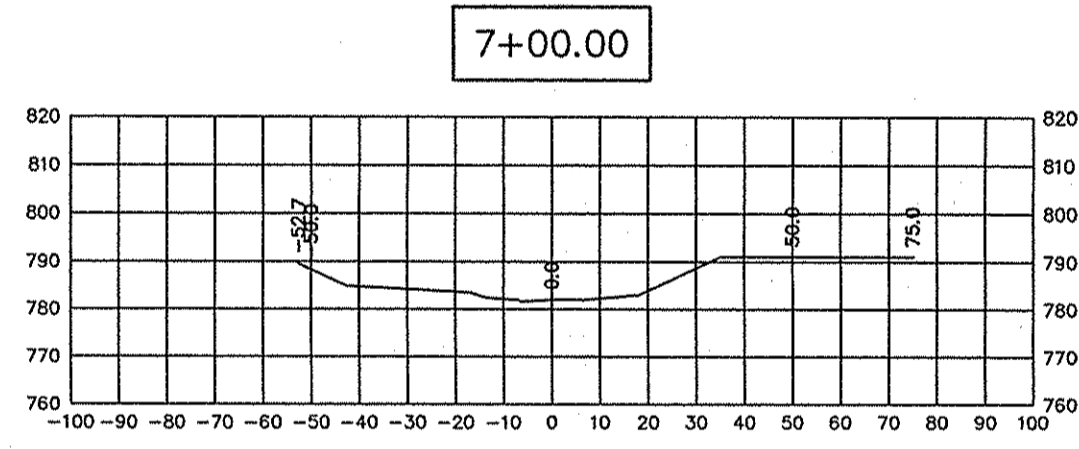
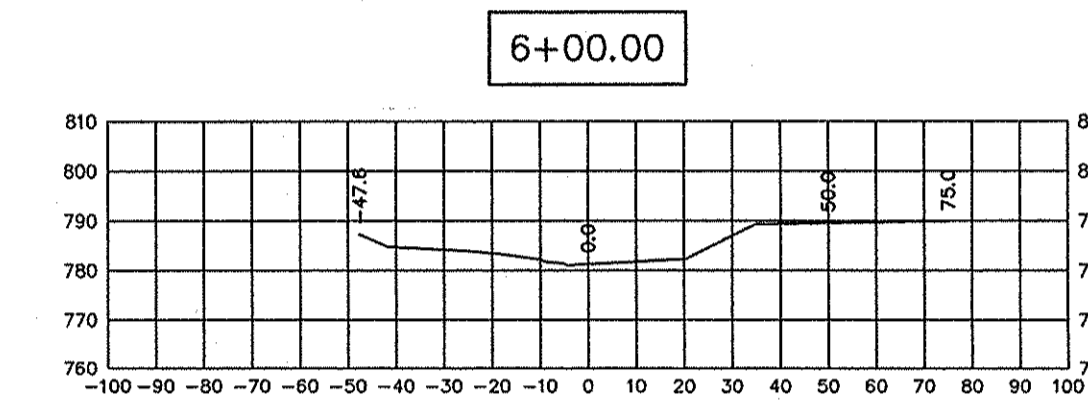
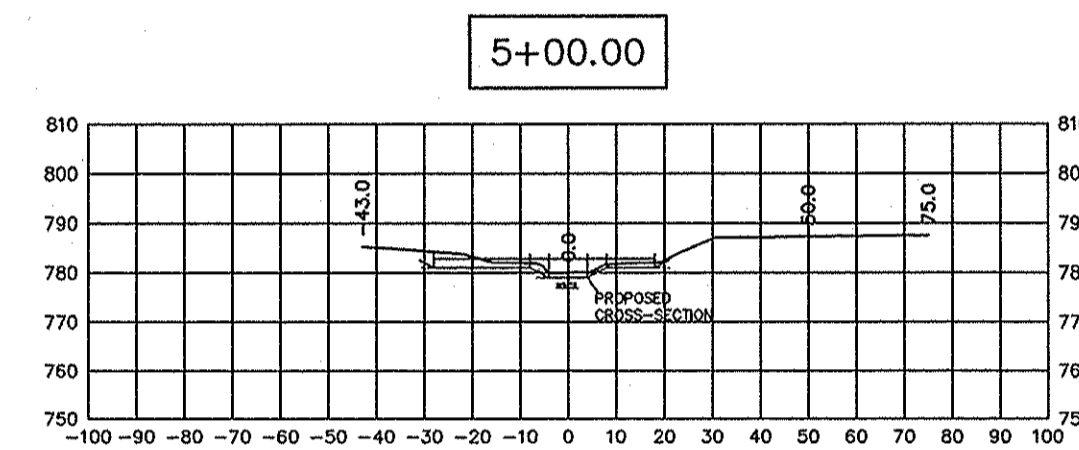
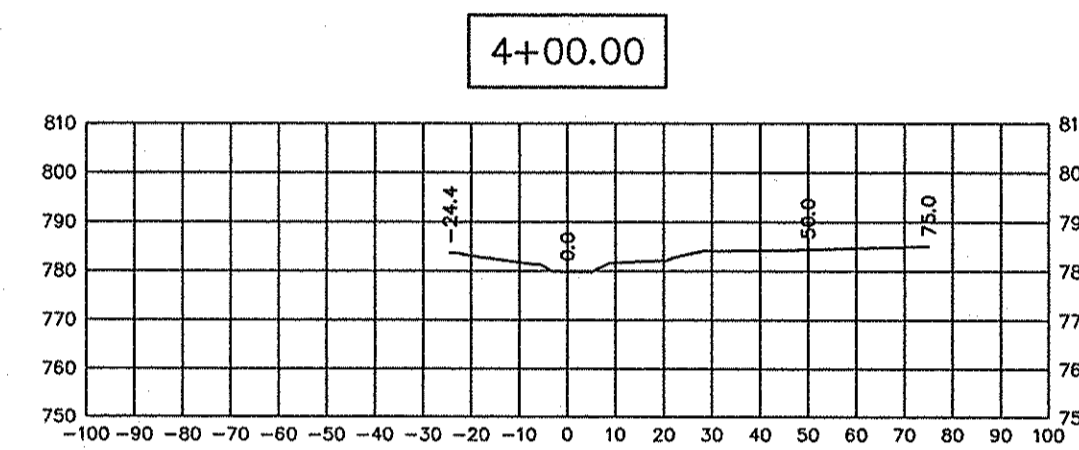
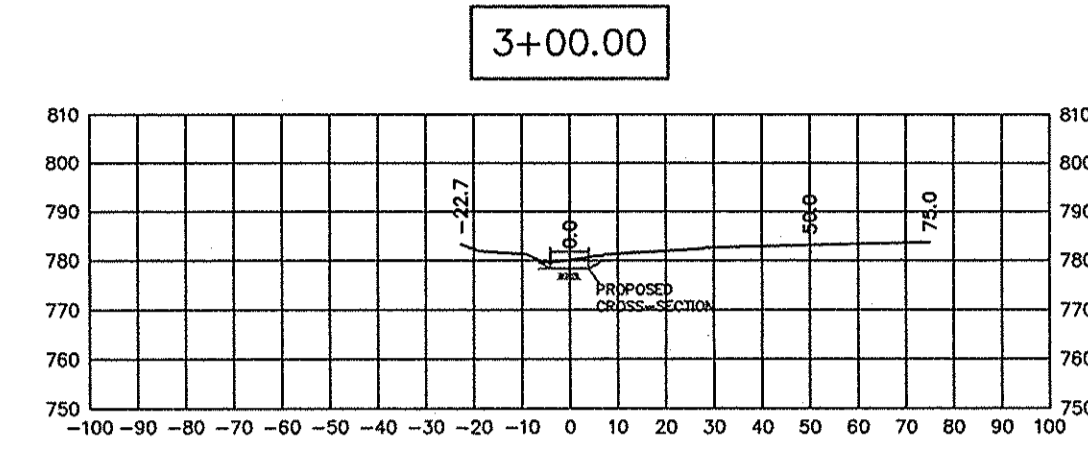
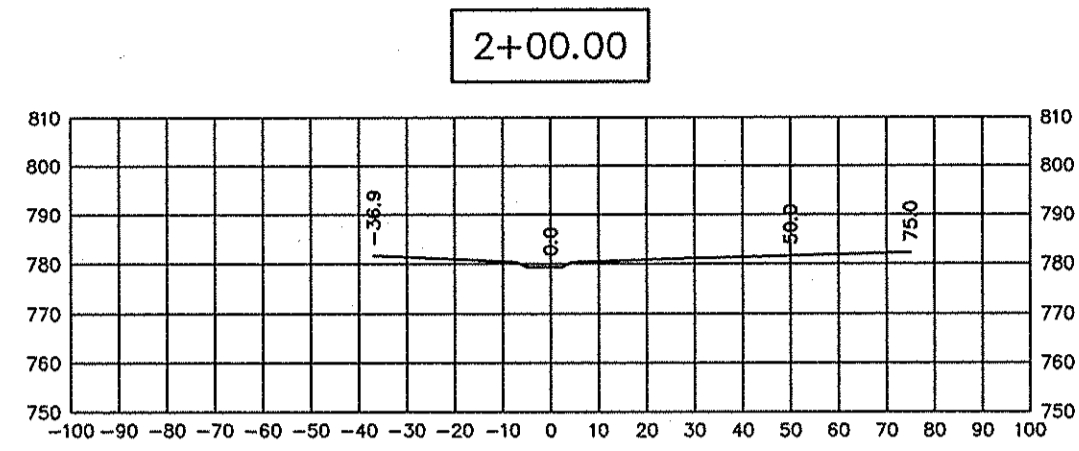
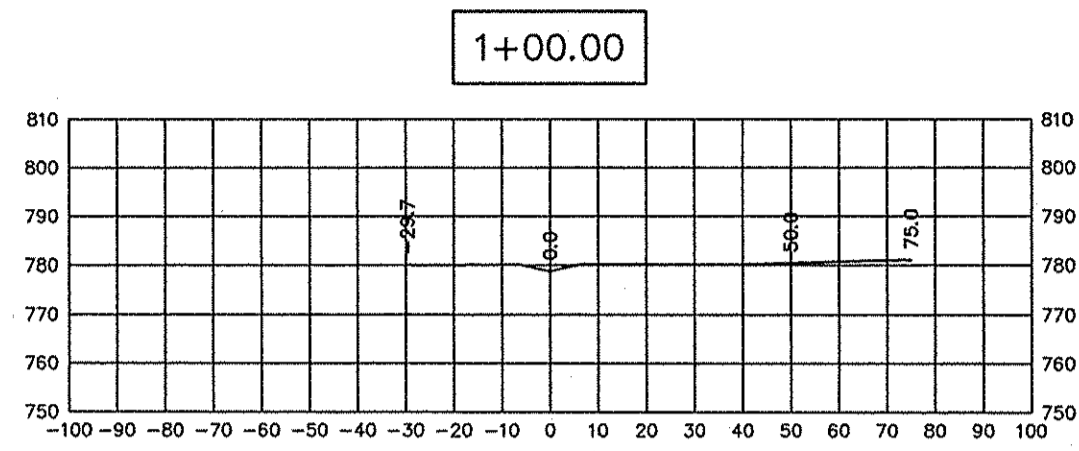

THE WITHIN PLAT AND SURVEY WAS PREPARED WITHOUT THE BENEFIT OF A CURRENT TITLE POLICY AND ARE THEREFORE SUBJECT TO ANY STATEMENT OF FACTS REVEALED BY EXAMINATION OF SCHEDULE "A" AND SCHEDULE "B" OF A TITLE POLICY.

THIS SURVEY PLAT HAS BEEN PREPARED FOR USE ON THIS PARTICULAR PROJECT AND FOR THE EXCLUSIVE USE OF THE PERSON(S) OR ENTITY HEREON NAMED AND IS NOT CERTIFIED TO OR TO BE USED BY ANY OTHER PARTY. THE EVIDENCE, POSSESSION, OWNERSHIP, CONDITIONS ETC. COULD CHANGE CONSTANTLY AND THE USE OF THIS SURVEY IS LIMITED ONLY TO THE DATE INDICATED HEREIN.

THE LOCATION OF THE TITLE LINES AND CORNERS ARE SUBJECT TO THE EVIDENCE FOUND IN THE PERFORMANCE OF THIS SURVEY. ADDITIONAL EVIDENCE PRESENTED TO MILLER SURVEYING, INC. MAY ALTER THE LOCATION OF THE TITLE LINES AND CORNERS.

BENCHMARK INFORMATION

HORIZONTAL AND VERTICAL CONTROL:

COORDINATE SYSTEM:
 US STATE PLANE 1983 (AT GROUND)

PROJECT DATUM:
 WORLD GEODETIC SYSTEM (WGS 1984)

VERTICAL DATUM
 NAVD 88

ZONE:
 INDIANA EAST 1301

GEOID MODEL:
 GEoid12A (CONUS)

COORDINATE UNITS US SURVEY FEET
 DISTANCE UNITS US SURVEY FEET
 HEIGHT UNITS US SURVEY FEET

CERTIFICATION BY SURVEYOR

The attached ASBUILT DRAWINGS, page PAGE 1 OF 1, to the best of my knowledge and belief a true and correct representation of the AS-BUILT REGULATED DRAINE installation.

K. Nathan Althouse
 Nathan Althouse #LS20400007

Date 2/24/2017
 Miller Surveying, Inc.
 948 Conner Street
 Noblesville, IN 46060
 (317) 773-2644
 000.00 = DESIGN VALUE
 (000.00) = AS-BUILT VALUE

4-22-2017

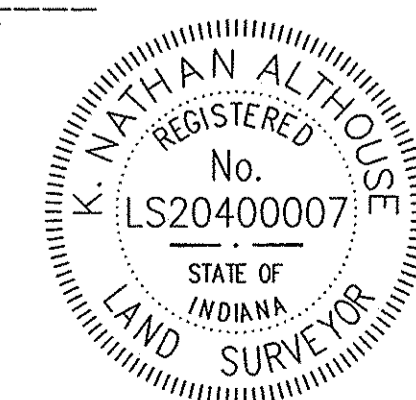

3-21-18 KNA REVISED ON PROPOSED PROFILE FILED

MAR 22 2018

OFFICE OF HAMILTON COUNTY SURVEYOR

 MILLER SURVEYING INC. 948 CONNER STREET NOBLESVILLE, INDIANA 46060 PH. # (317) 773-2644 FAX 773-2694		

AS-BUILT SURVEY

WEAVER AND HOOKE DRAIN
 PART OF THE S.W. 1/4, SECTION 35-19-5
 WAYNE TOWNSHIP, HAMILTON COUNTY, INDIANA

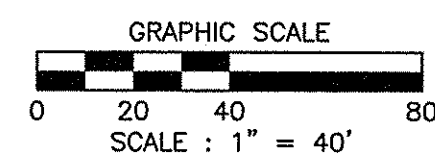
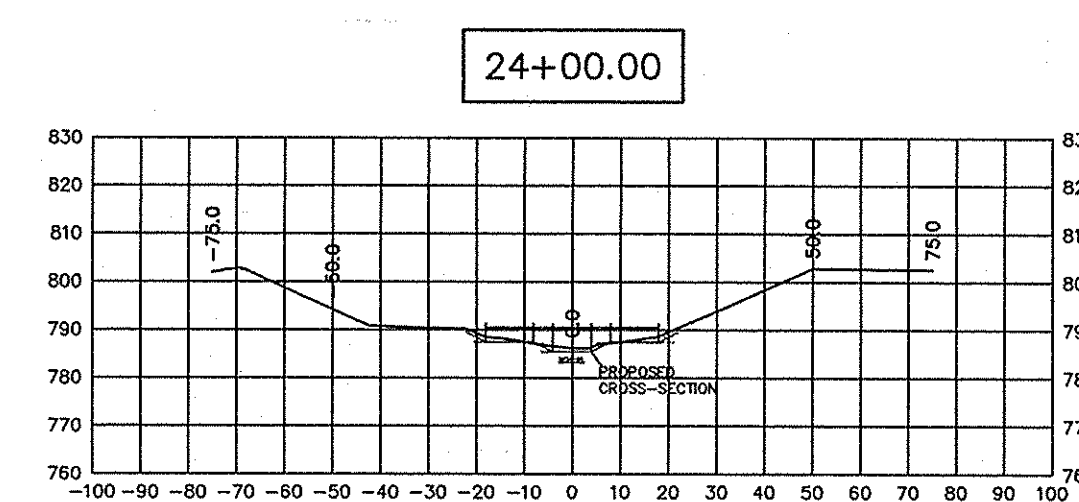
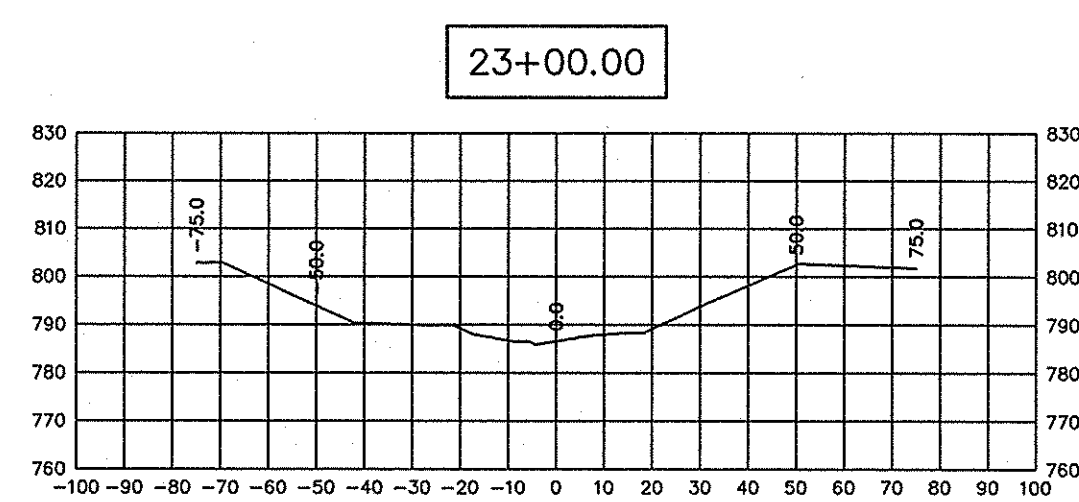
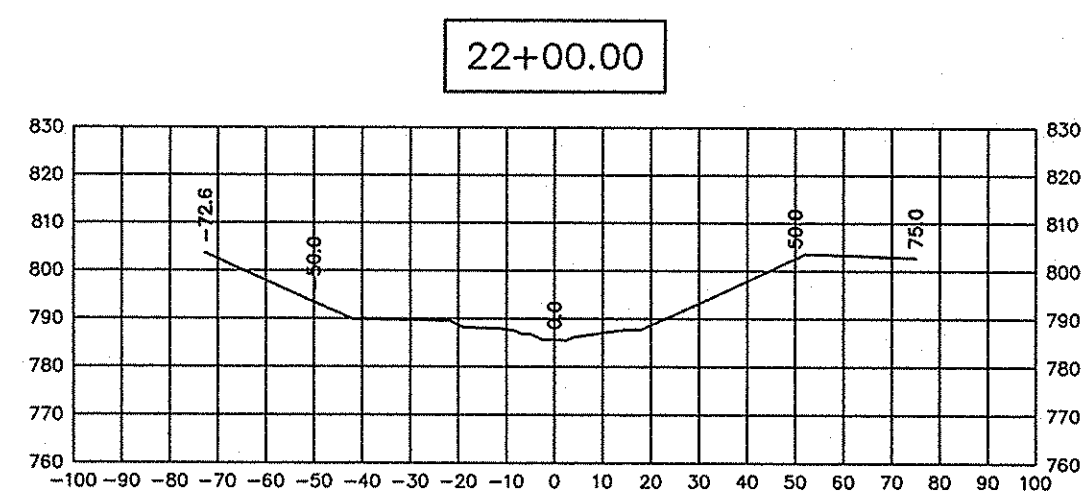
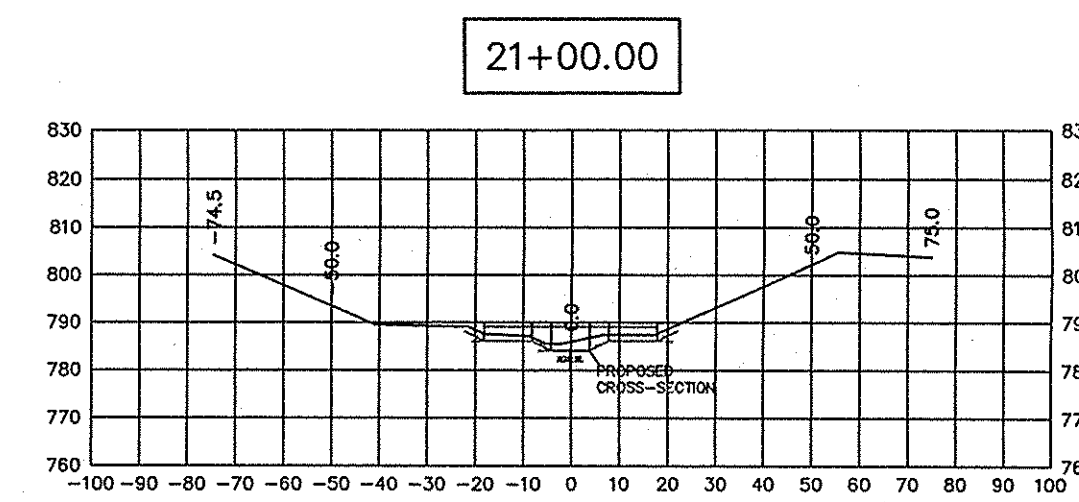
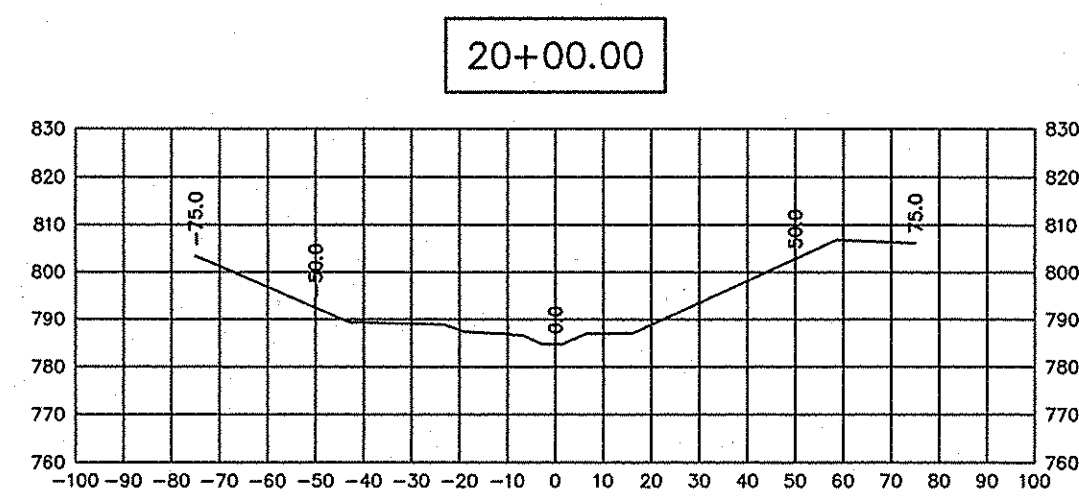
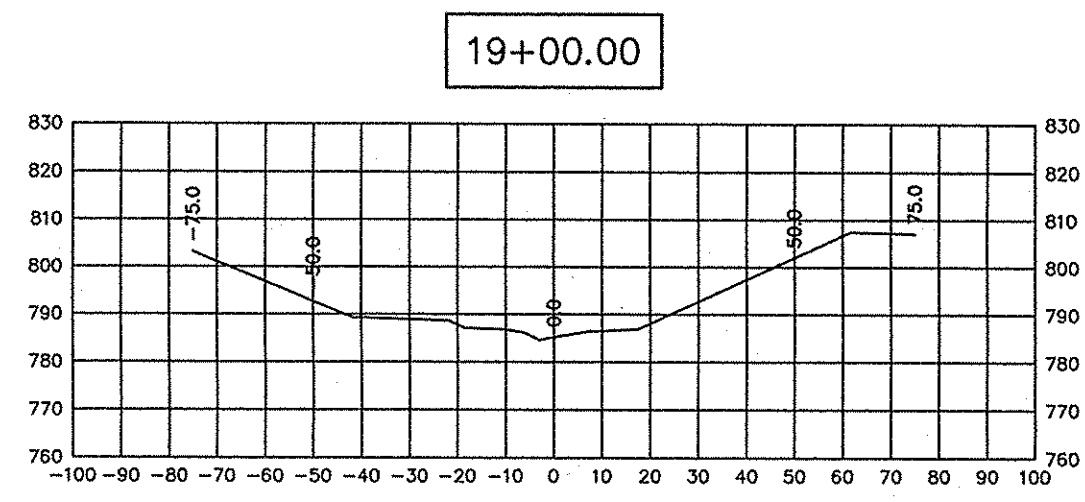
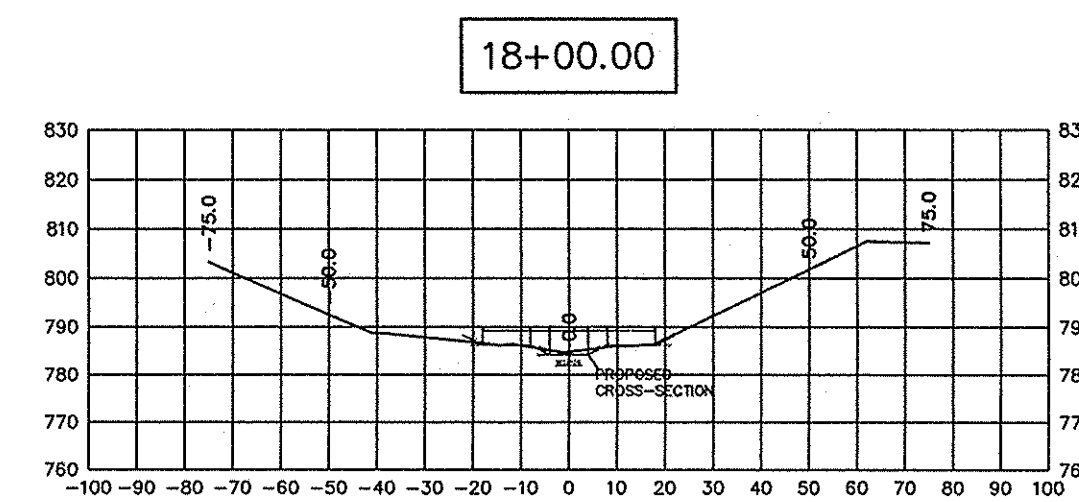
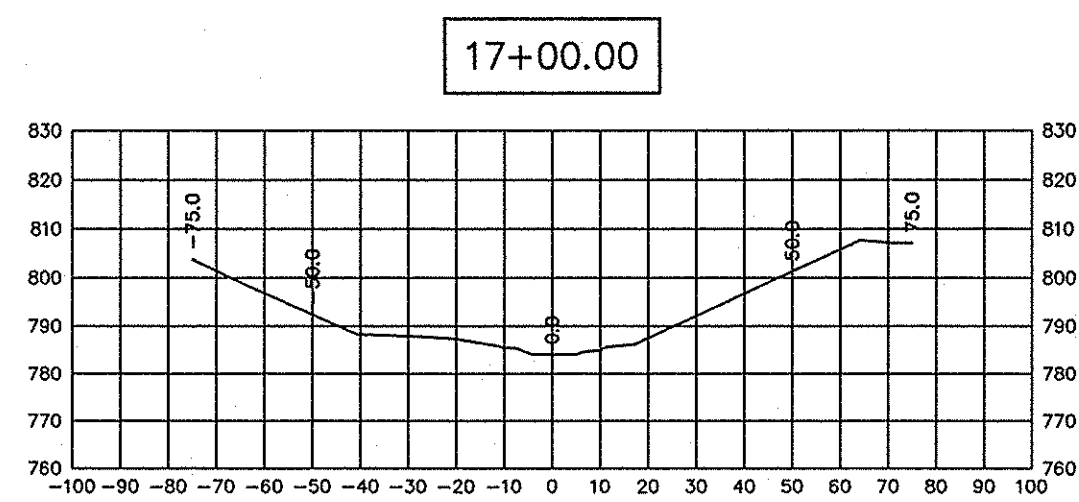
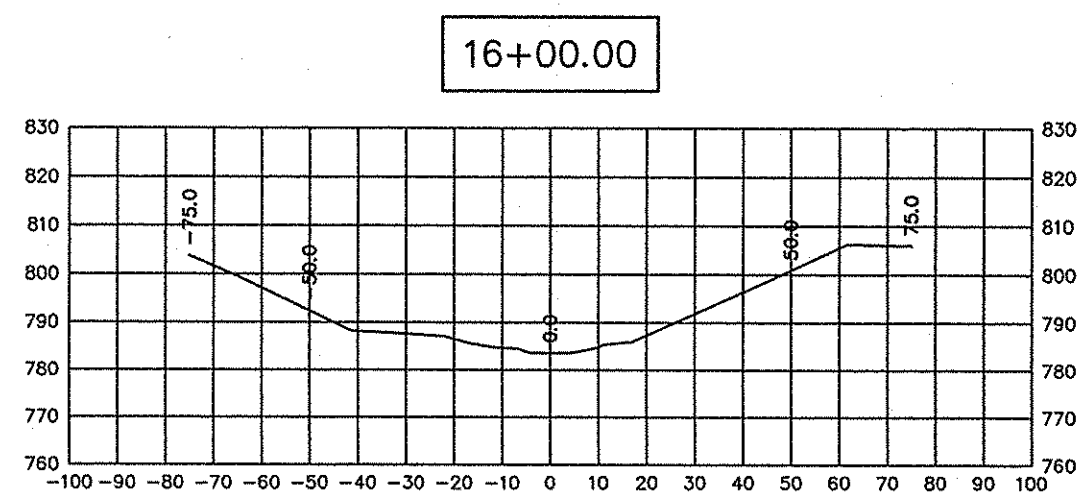
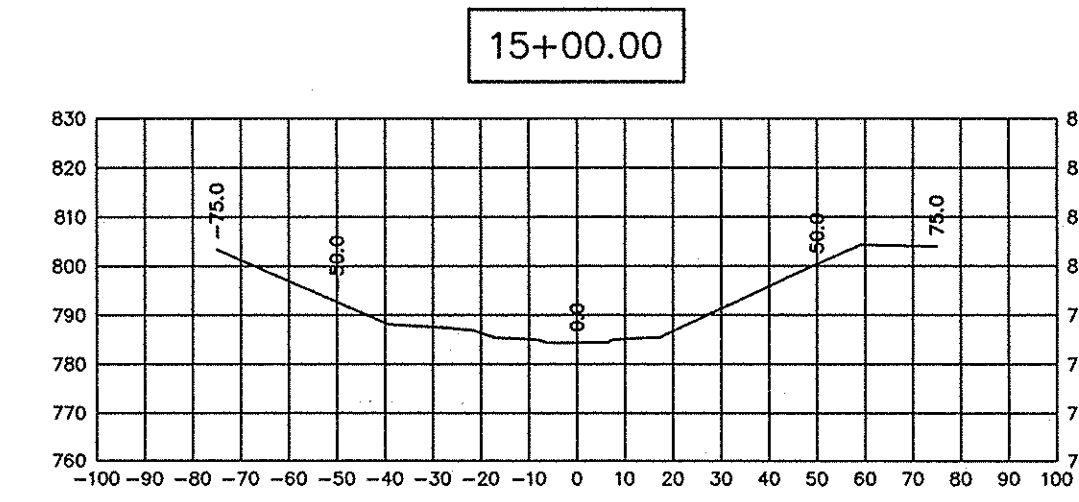
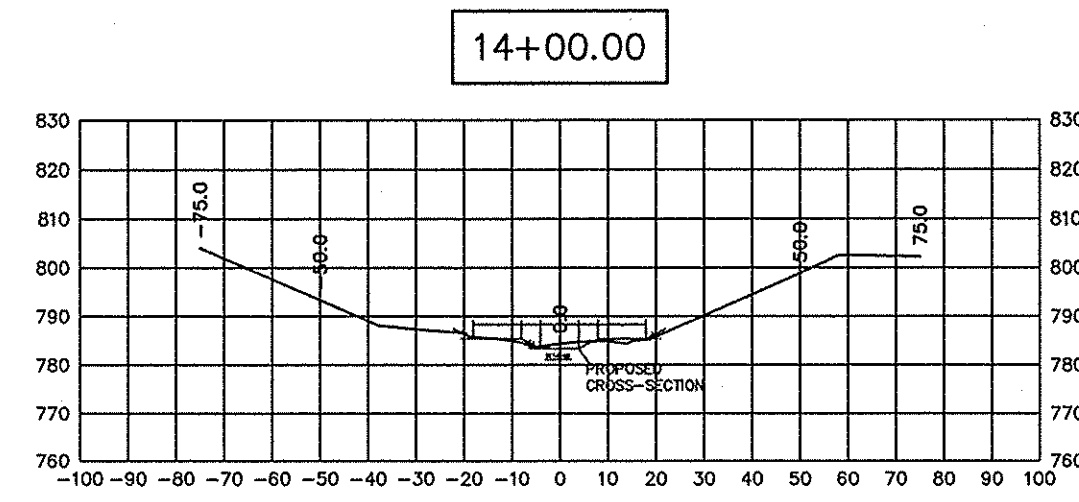
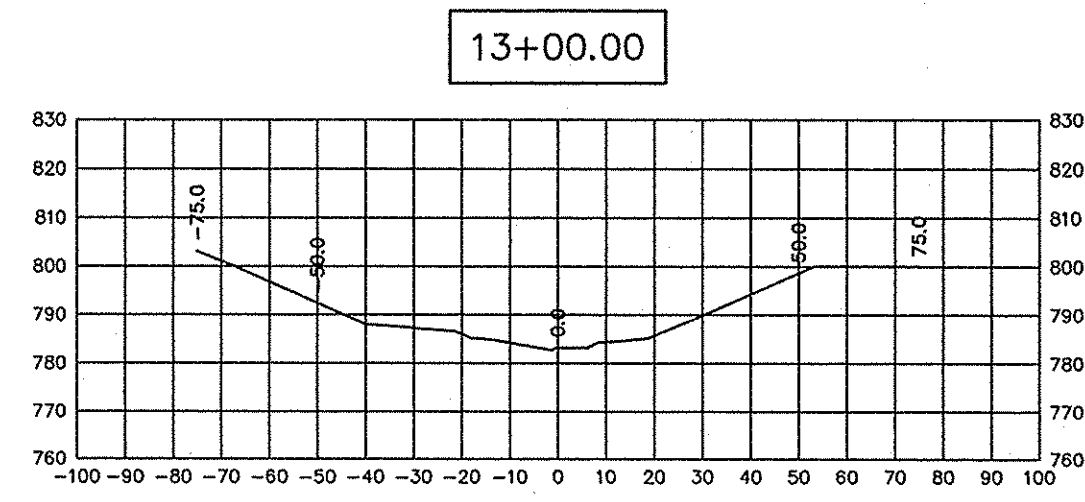

THE WITHIN PLAT AND SURVEY WAS PREPARED WITHOUT THE BENEFIT OF A CURRENT TITLE POLICY AND ARE THEREFORE SUBJECT TO ANY STATEMENT OF FACTS REVEALED BY EXAMINATION OF SCHEDULE "A" AND SCHEDULE "B" OF A TITLE POLICY.

THIS SURVEY PLAT HAS BEEN PREPARED FOR USE ON THIS PARTICULAR PROJECT AND FOR THE EXCLUSIVE USE OF THE PERSON(S) OR ENTITY HEREON NAMED AND IS NOT CERTIFIED TO OR TO BE USED BY ANY OTHER PARTY. THE EVIDENCE, POSSESSION, OWNERSHIP, CONDITIONS ETC. COULD CHANGE CONSTANTLY AND THE USE OF THIS SURVEY IS LIMITED ONLY TO THE DATE INDICATED HEREIN.

THE LOCATION OF THE TITLE LINES AND CORNERS ARE SUBJECT TO THE EVIDENCE FOUND IN THE PERFORMANCE OF THIS SURVEY. ADDITIONAL EVIDENCE PRESENTED TO MILLER SURVEYING, INC. MAY ALTER THE LOCATION OF THE TITLE LINES AND CORNERS.

BENCHMARK INFORMATION

HORIZONTAL AND VERTICAL CONTROL:

COORDINATE SYSTEM:
 US STATE PLANE 1983 (AT GROUND)

PROJECT DATUM:
 WORLD GEODETIC SYSTEM (WGS 1984)

VERTICAL DATUM
 NAVD 88

ZONE:
 INDIANA EAST 1301

GEOID MODEL:
 GEOID12A (CONUS)

COORDINATE UNITS US SURVEY FEET
 DISTANCE UNITS US SURVEY FEET
 HEIGHT UNITS US SURVEY FEET

CERTIFICATION BY SURVEYOR

The attached ASBUILT DRAWINGS, page PAGE 1 OF 1, to the best of my knowledge and belief a true and correct representation of the AS-BUILT REGULATED DRAINE installation.

K. Nathan Althouse

4-22-2017

Nathan Althouse #LS20400007
 Date 2/24/2017
 Miller Surveying, Inc.
 948 Conner Street
 Noblesville, IN 46060
 (317) 773-2644
 000.00 = DESIGN VALUE
 (000.00) = AS-BUILT VALUE



3-21-18 KNA REVISED ON PROPOSED PROFILE FILED

MAR 22 2018

OFFICE OF HAMILTON COUNTY SURVEYOR

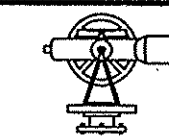

MILLER SURVEYING INC.

948 CONNER STREET
 NOBLESVILLE INDIANA 46060
 PH. # (317) 773-2644 FAX 773-2694

LOCATION: PART OF THE S.W. 1/4 SECTION 35-19-5 WAYNE TOWNSHIP, HAMILTON COUNTY, INDIANA	DRAWN BY: KNA	PREPARED BY: KNA
FIELD WORK COMPLETED: 2/14/2017	SCALE: 1" = 200'	FIELD BOOK:
CLIENT: IMI	DATE: 2/22/2017	PAGE:
DESCRIPTION: AS-BUILT	JOB NUMBER	SURVEY 4 FILE:
	B37070	

AS-BUILT SURVEY

WEAVER AND HOOKE DRAIN
PART OF THE S.W. 1/4, SECTION 35-19-5
WAYNE TOWNSHIP, HAMILTON COUNTY, INDIANA

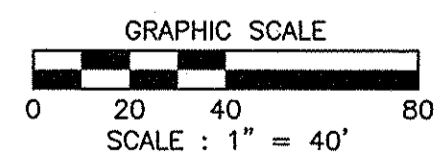
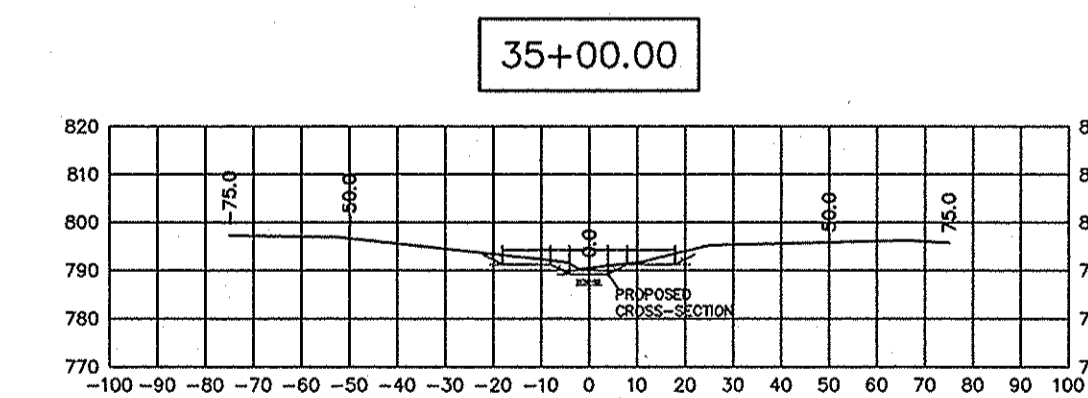
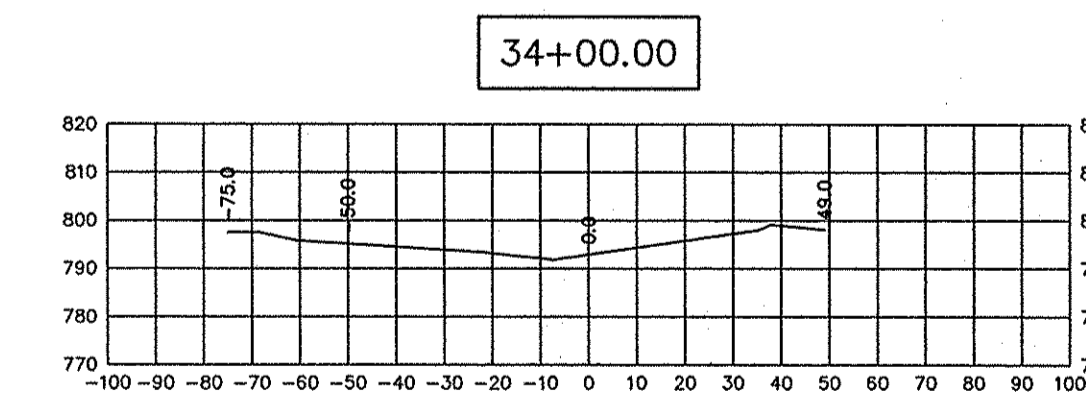
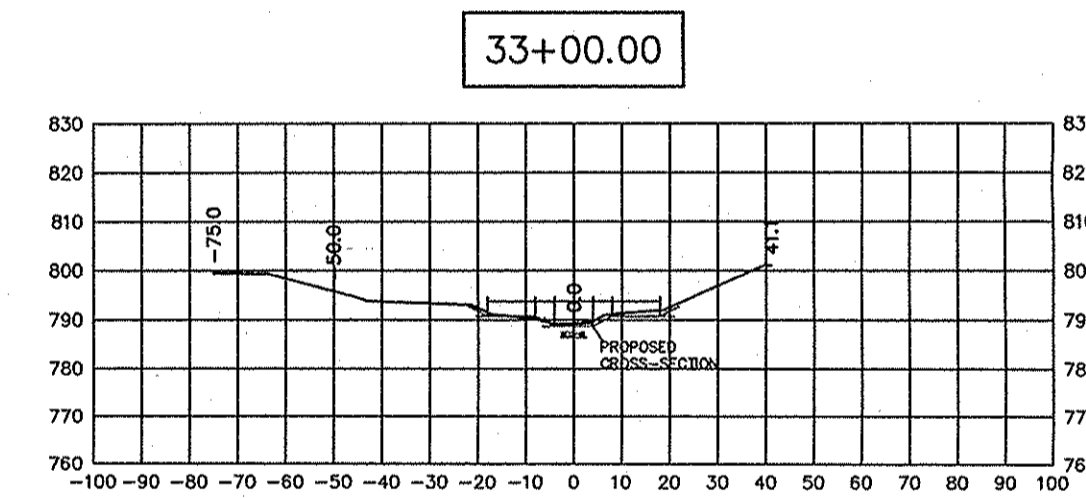
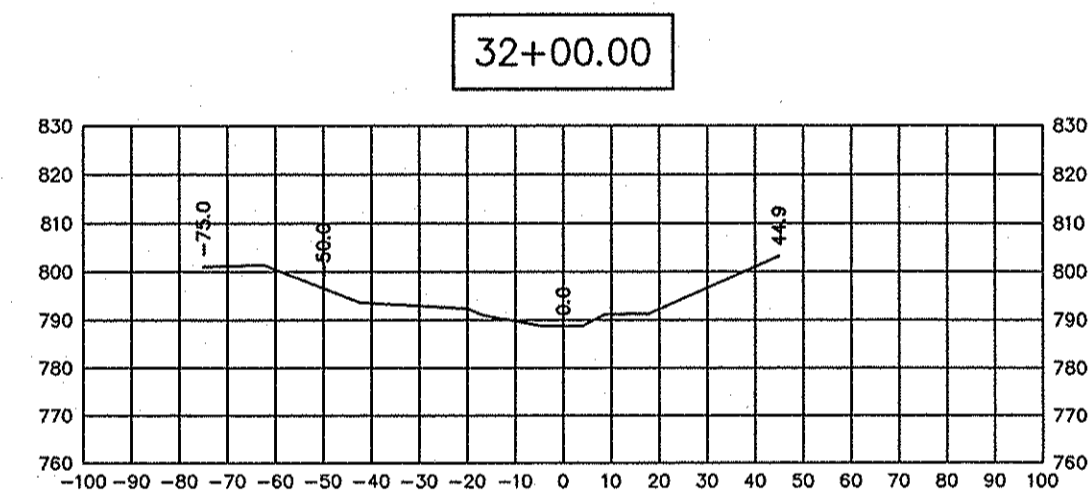
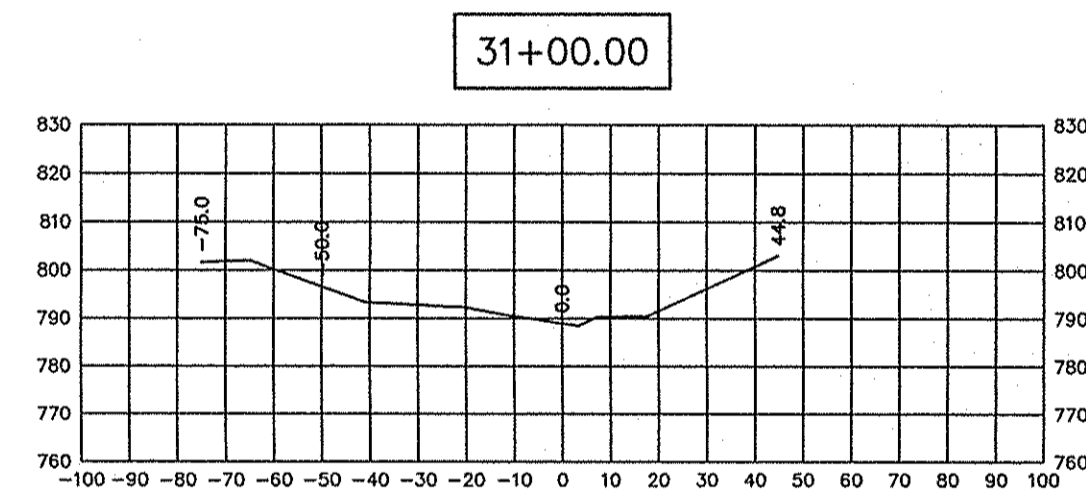
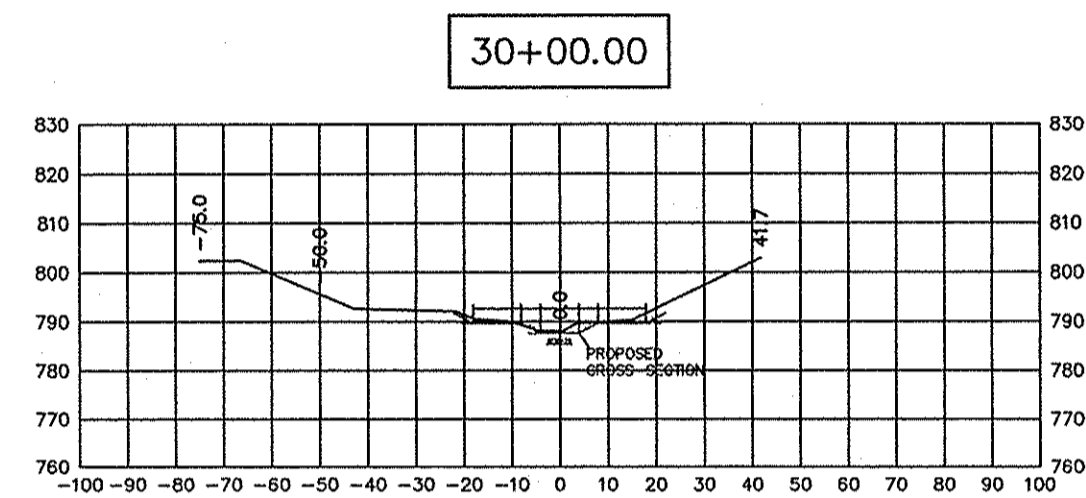
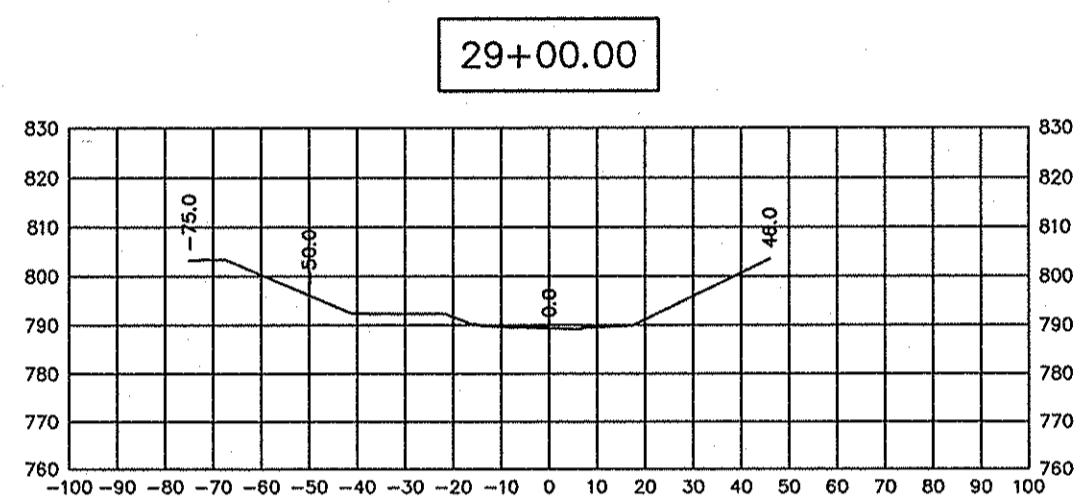
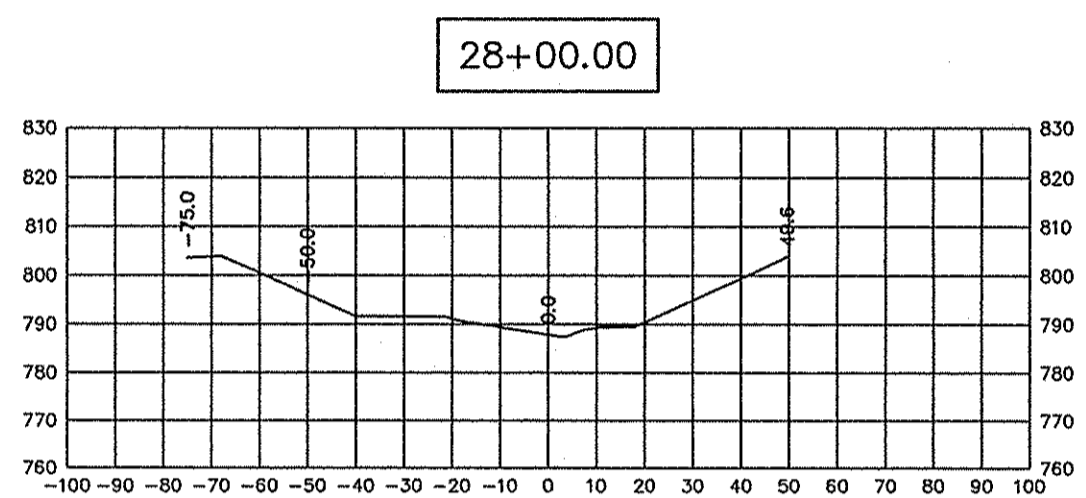
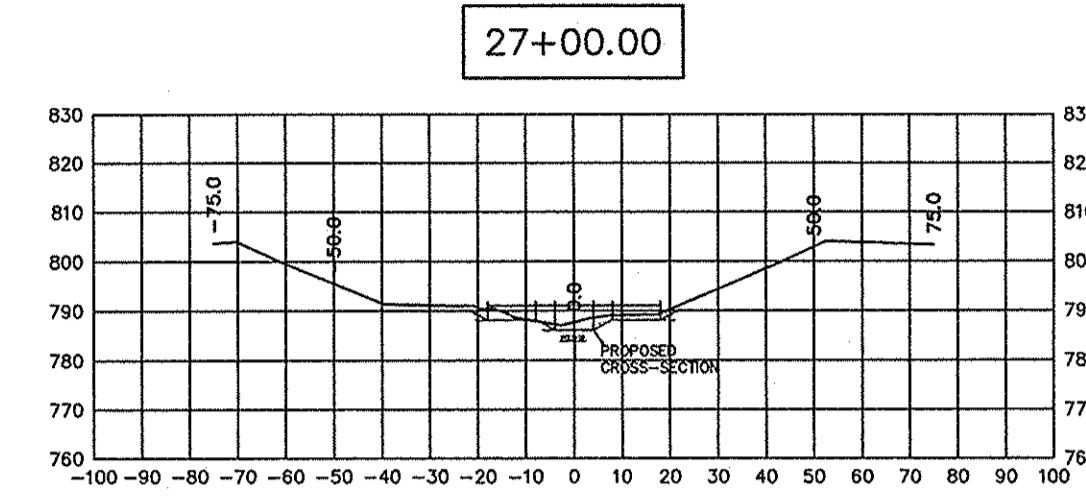
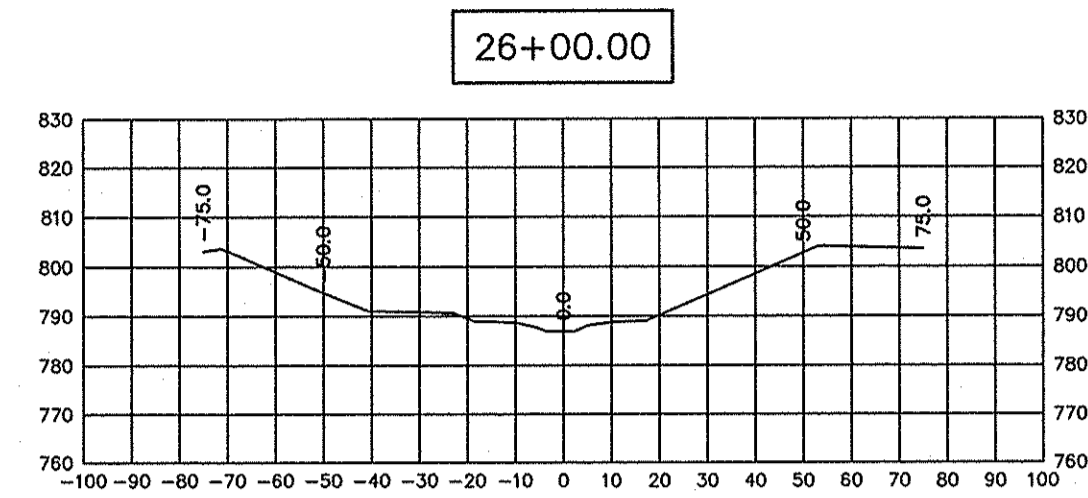
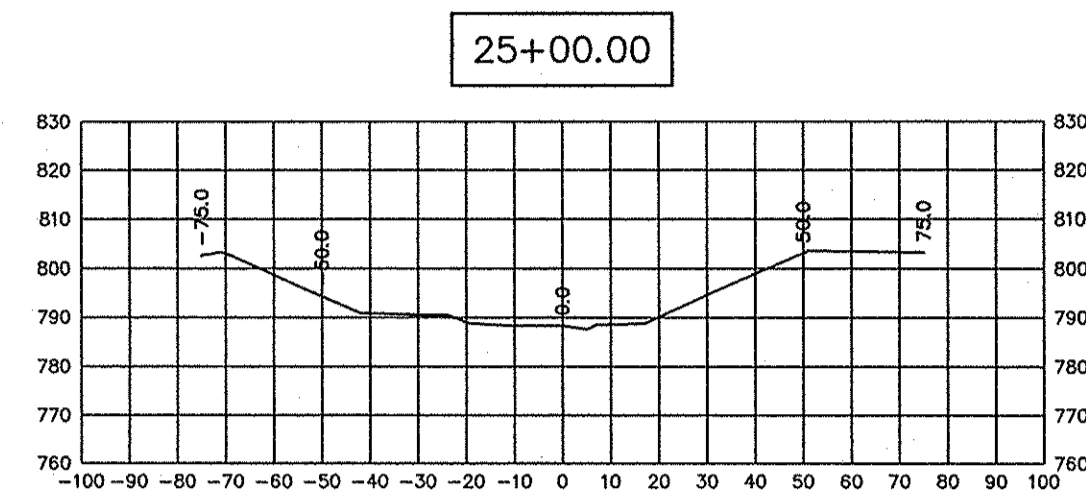

THE WITHIN PLAT AND SURVEY WAS PREPARED WITHOUT THE BENEFIT OF A CURRENT TITLE POLICY AND ARE THEREFORE SUBJECT TO ANY STATEMENT OF FACTS REVEALED BY EXAMINATION OF SCHEDULE "A" AND SCHEDULE "B" OF A TITLE POLICY.

THIS SURVEY PLAT HAS BEEN PREPARED FOR USE ON THIS PARTICULAR PROJECT AND FOR THE EXCLUSIVE USE OF THE PERSON(S) OR ENTITY HEREON NAMED AND IS NOT CERTIFIED TO OR TO BE USED BY ANY OTHER PARTY. THE EVIDENCE, POSSESSION, OWNERSHIP, CONDITIONS ETC. COULD CHANGE CONSTANTLY AND THE USE OF THIS SURVEY IS LIMITED ONLY TO THE DATE INDICATED HEREIN.

THE LOCATION OF THE TITLE LINES AND CORNERS ARE SUBJECT TO THE EVIDENCE FOUND IN THE PERFORMANCE OF THIS SURVEY. ADDITIONAL EVIDENCE PRESENTED TO MILLER SURVEYING, INC. MAY ALTER THE LOCATION OF THE TITLE LINES AND CORNERS.

BENCHMARK INFORMATION

HORIZONTAL AND VERTICAL CONTROL:

COORDINATE SYSTEM:
US STATE PLANE 1983 (AT GROUND)

PROJECT DATUM:
WORLD GEODETIC SYSTEM (WGS 1984)

VERTICAL DATUM
NAVD 88

ZONE:
INDIANA EAST 1301

GEOID MODEL:
GEOID12A (CONUS)

COORDINATE UNITS US SURVEY FEET
DISTANCE UNITS US SURVEY FEET
HEIGHT UNITS US SURVEY FEET

CERTIFICATION BY SURVEYOR

The attached ASBUILT DRAWINGS, page PAGE 1 OF 1, to the best of my knowledge and belief a true and correct representation of the AS-BUILT REGULATED DRAINE installation.

K. Nathan Althouse
Nathan Althouse #LS20400007

Date 2/24/2017
Miller Surveying, Inc.
948 Conner Street
Noblesville, IN 46060
(317) 773-2644
000.00 = DESIGN VALUE
(000.00) = AS-BUILT VALUE

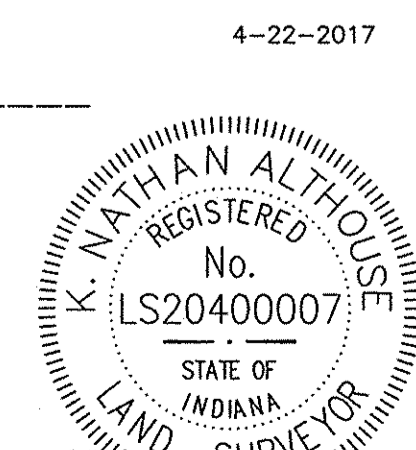

4-22-2017

3-21-18 KNA REVISED ON PROPOSED PROFILE **FILED**

MAR 22 2018

OFFICE OF HAMILTON COUNTY SURVEYOR

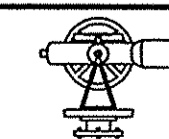

MILLER SURVEYING INC.

948 CONNER STREET
NOBLESVILLE INDIANA 46060
PH. # (317) 773-2644 FAX 773-2694

LOCATION: PART OF THE S.W. 1/4 SECTION 35-19-5 WAYNE TOWNSHIP, HAMILTON COUNTY, INDIANA	DRAWN BY: KNA	PREPARED BY: KNA
FIELD WORK COMPLETED: 2/14/2017	SCALE: 1" = 200'	FIELD BOOK:
CLIENT: IMI	DATE: 2/22/2017	PAGE:
DESCRIPTION: AS-BUILT	JOB NUMBER	SURVEY 4 FILE:
		B37070